

LED

IP 66

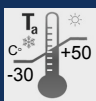

IK08



- Central locking with internal switch
- Through-wiring possible
- LED modules with innovative encapsulation
- Estimated service life up to 70 000 hours
- High color rendering index CRI 80
- Luminous efficacy 154lm/W
- With OVP, OCP, OTP protection
- Autonomous reactivation after recovery
- Color temperature: 4000K

PSF LED / PSF LED-E

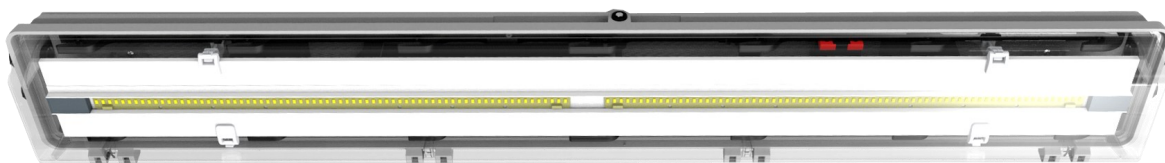

CONSTRUCTION

Housing: SMC polyester plastic reinforced with glass fiber, color RAL 7038
 Diffuser: PC polycarbonate plastic
 Gasket: silicone
 Central locking: can be opened/closed using a socket key SW8, hinged lamp cover
 The light fitting is normally supplied with socket key, two Ex e cable glands M25, two Ex e plugs M25 and with mounting set PSF 30-110

TECHNICAL DATA

Certificate:	EXA 18 ATEX 0004
Marking:	CE 0722
Apparatus category:	II 2G II 2D
Marking of explosion protection:	Ex db eb mb op is IIC T4 Gb Ex tb op is IIIC T80°C Db
Ambient temperature:	-30°C ≤ T _a ≤ +55°C -30°C ≤ T _a ≤ +40°C 0°C ≤ T _a ≤ +40°C (PSF LED-E, emergency LF)
Degree of protection:	IP 66 category 1
Resistance to shock:	IK 08
Protection class :	I (protective earthing)
Rated voltage:	230 V AC
Frequency:	50-60 Hz
Rated power:	See model code table
Estimated service life:	PSF 28 LED-1, PSF 52 LED-1 60 000 hours PSF 28 LED-2, PSF 52 LED-2 70 000 hours
Connecting terminals:	L1, L2, L3, N, PE - max. 2,5 mm ²
Cable entry:	Two entries Ex e M25x1,5 for cable diameters Ø6-15 mm, and two Ex e plugs
Battery:	NiCd, 4,8V/4Ah
Nominal autonomy:	1,5h or 3h
Packing:	The packing contains: 1 pcs PSF 52 LED: 1420x270x210 mm PSF 28 LED: 825x270x210 mm

MOUNTING

Pendant, on pipe, wall, ceiling

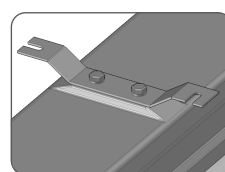
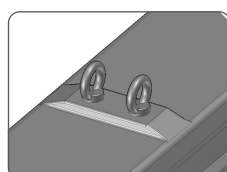
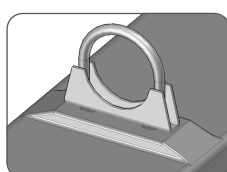
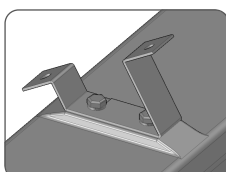

MODEL CODE

MODEL CODE	LED POWER [W]	VOLTAGE [V]	LUMINOUS FLUX [lm]	LIGHT OUTPUT RATIO η	AMBIENT TEMP.	WEIGHT
PSF 28 LED-2	37 W	220-250VAC	5580 lm	0,84	$-30^{\circ}\text{C} \leq T_a \leq +40^{\circ}\text{C}$	8,0 kg
PSF 52 LED-2	70 W		11100 lm			12,0 kg

PSF 28 LED-1	28 W	220-250VAC	4600 lm	0,84	$-30^{\circ}\text{C} \leq T_a \leq +55^{\circ}\text{C}$	8,0 kg
PSF 52 LED-1	52 W		9100 lm			12,0 kg

Special types for the ambient temperature $-20^{\circ}\text{C} \leq T_a \leq +55^{\circ}\text{C}$

MODEL CODE	LED power [W]	VOLTAGE [V]	LUMINOUS FLUX [lm]	1,5h autonomy LUM [lm]	3h autonomy LUM [lm]	AMBIENT TEMP.	WEIGHT
PSF 28 LED-E	26 W	220-250VAC	4600 lm	685 lm	460 lm	$-0^{\circ}\text{C} \leq T_a \leq +40^{\circ}\text{C}$	9,0 kg
PSF 52 LED-E	48 W		9100 lm	1000 lm	550lm		13,0 kg

POLAR CURVE

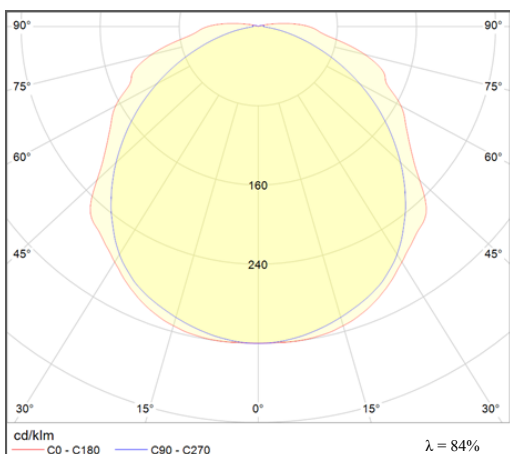

DIMENSION DRAWING (all dimensions in mm)

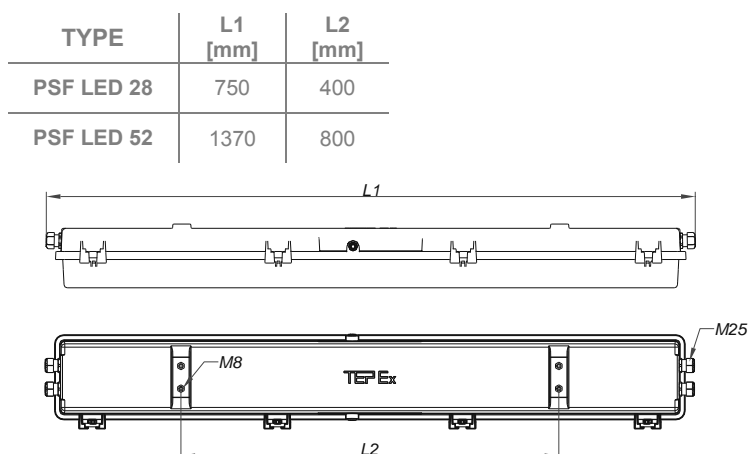

SPARE PARTS AND ACCESSORIES

SKETCH	DESCRIPTION	CODE	SKETCH	DESCRIPTION	CODE
	Diffuser PSF	PSF LED 28 10-120 PSF LED 52 20-120		Ex e cable gland SPU 25	SPU 25
	Gasket PSF	PSF LED 28 10-130 PSF LED 52 20-130		Ex e plug M25	SPC 25
	Internal reflector with LED module	PSF LED 28 10-140 PSF LED 52 20-140		PSF Ceiling mounting set	PSF 30-110
	LED driver	PSF LED 28 drive PSF LED 52 drive		PSF Pipe mounting set	PSF 30-120
	LED difuzor	PSF LED 30-180		PSF Wall mounting set	PSF 30-130
	Socket key SW8	PSF236 20-160		Ring bolt M8	PSF 30-140

All technical data is relevant at the time of print.