

CONSTRUCTION

Housing: SMC polyester plastic reinforced with glass fiber

Diffuser: PC polycarbonate plastic

Gasket: silicone

Central locking: can be opened/closed using a socket key SW8, hinged lamp cover

The light fitting is normally supplied without light sources, with socket key, two Ex e cable glands M25, two Ex e plugs M25 and with four ring screw M8 (pendant version).

TECHNICAL DATA

Certificate:	EXA 13 ATEX 0014/3
Marking:	CE 0722
Apparatus category:	II 2GD
Marking of explosion protection:	 Ex db eb mb IIC T4 Gb Ex tb IIIC T80°C Db
Ambient temperature:	-20°C ≤ Ta ≤ +40°C
Degree of protection:	IP 66, category 1
Resistance to shock:	IK 08
Protection class :	I (protective earthing)
Rated voltage:	220....240 V (±10%)
Frequency:	50/60 Hz
Power factor:	λ=0,95
Ballast lumen factor:	98%
Light output ratio:	η=0,78%
Battery:	PSF 218E - Ni-Mh Saft VHT D, 4,8V 6Ah PSF 236E - Ni-Mh Saft VHT F, 4,8V 10Ah
Nominal autonomy:	1,5 / 3 hours
Connecting terminals:	L1, L2, L3, N, PE - max. 2,5 mm ²
Cable entry:	Two entries Ex e M25x1,5 for cable diameters Ø6-15 mm, and two Ex e plugs
Piktogram:	300x150mm
Packing:	The packing contains: 1 pcs PSF 236 : 1420x270x210 mm PSF 218 : 825x270x210 mm

- 1,5 or 3h autonomy
- Maintained / Non maintained operation
- Ni-Mh battery

Emergency fluorescent light fitting

MODEL CODE

Model code	Max. Wattage	Lamp type	Nominal voltage	Luminous flux [lm]	Luminous flux bat. mod [lm]	Lamp holder	Nominal operational current	Weight
PSF 218	2x18 W	T8	230 V	2 x 1350	1,5h 60% (800lm) 3h 40% (550lm)	G13	0,18 A	9,0 kg
PSF 236	2x36 W			2 x 3350	1,5h 60% (2000lm) 3h 30% (1000lm)		0,33 A	12,5 kg

POLAR CURVE

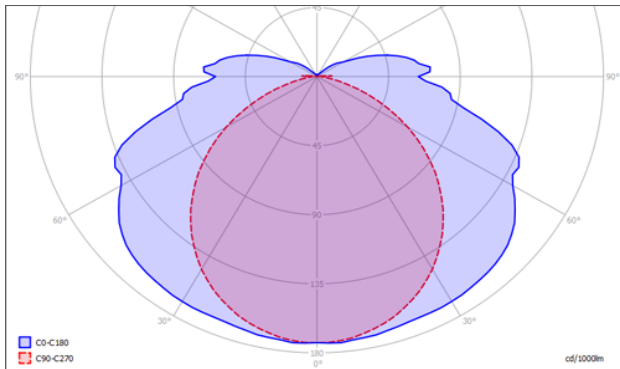

MOUNTING

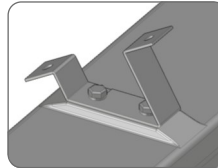

Pendant, on pipe, wall, ceiling

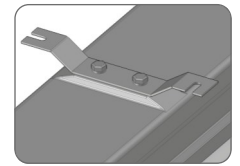
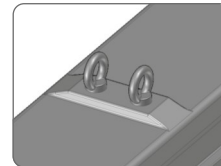
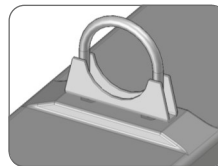

DIMENSION DRAWING (all dimensions in mm)

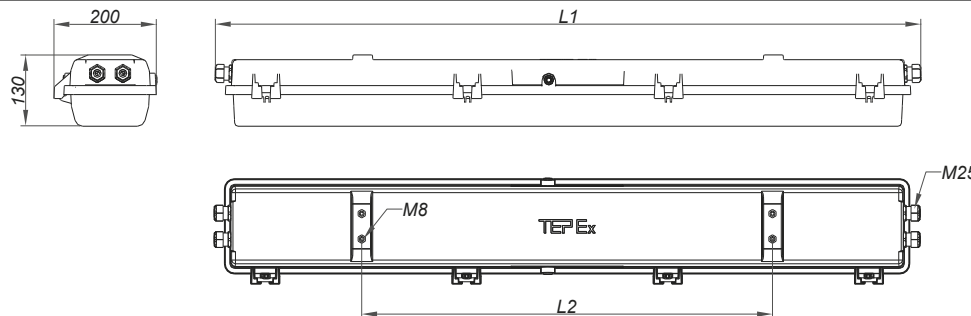

	L1 [mm]	L2 [mm]
PSF 218 E	750	400
PSF 236 E	1370	800

SPARE PARTS AND ACCESSORIES

SKETCH	DESCRIPTION	MODEL CODE	SKETCH	DESCRIPTION	MODEL CODE
	Diffuser PSF	PSF 218 10-120 PSF 236 20-120		Ex e cable gland	SPU 25
	Gasket PSF	PSF 218 10-130 PSF 236 20-130		Ec e plug	SPC 25
	Internal reflector with lamp holder	PSF 218 10-140 PSF 236 20-140		Ceiling mounting, set	PSF 30-110
	Pendant mounting, set	PSF 30-150		Pipe mounting, set	PSF 30-120
	Battery module	BATEX 01/6 BATEX 01/10		Wall mounting, set	PSF 30-130
	Terminals 8x0,5 – 4mm ² , set	PSF 218E 10-150		Metal cable glands for armoured cable M25 13-21mm	PSF 30-160
	Signal LED indicator	LEDEX 02		Socket key SW8	PSF218 20-160
	Terminal	SL2		Ring bolt M8	PSF 30-140
	Electronic ballast and inverter for emergency lighting	SMPE 15/18 SMPE 15/36		Piktograms - DIN 4844-2	PSF 30-170

All technical data is relevant at the time of print.